

A. PVC HUB SHALL CONFORM TO ASTM 3034, SDR 35. DRIVE HUB INTO CENTER OF RUBBER SLEEVE AFTER SLEEVE IS PLACED IN HOLE.

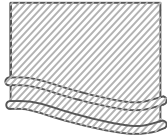

B. STAINLESS STEEL BAND SECURES UPPER HALF OF RUBBER SLEEVE TO THE PVC HUB. STAINLESS STEEL BAND SHALL BE 300 SERIES, $\frac{3}{16}$ " BAND WIDTH, CADMIUM PLATED CARBON STEEL, AND ATTACHED WITH HEX HEAD SLOTTED SCREW.



C. COMPLETE RUBBER SLEEVE INCLUDES A MOLDED SEGMENT THAT HOLDS IT IN PLACE.

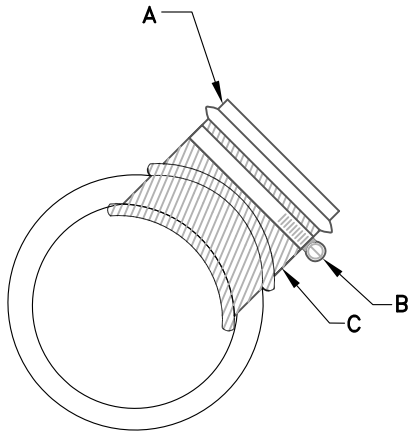

NOTE:

1. MAINLINE PIPE AND TAPPING FITTING SHALL BE COMPATIBLE. ONLY MANUFACTURED FITTINGS, EQUIVALENT TO INSERTA-TEE, SHALL BE USED.
2. ALL TAPPING HOLES SHALL BE MACHINE DRILLED AND CORED.
3. THE MAINLINE PIPE SHALL BE AT LEAST TWO SIZES (NORMAL I.D.) LARGER THAN THE TAPPING TEE.
4. COMPRESSION FITTING INTO CORED WALL TAPPING TEES ARE NOT ALLOWED DIRECTLY INTO THE TOP OF THE MAINLINE PIPE, NOR AT THE SPRINGLINE OF THE MAINLINE PIPE. COMPRESSION FITTING INTO CORED WALL TAPPING TEES MAY BE USED ONLY WHEN THE TAP IS AT APPROXIMATELY 45 DEGREES FROM THE VERTICAL OF THE MAINLINE PIPE.
5. SEAT TAPPING TEE IN PLACE TO FIT OUTSIDE SURFACE OF MAINLINE PIPE AND TO FORM A WATERTIGHT SEAL.
6. THE TAPPING TEE SHALL NOT PROTRUDE INTO THE MAINLINE PIPE, EXCEPT AS APPROVED BY THE CITY ENGINEER.



City of Lake Oswego
Engineering Division

Erica Rooney, P.E. City Engineer

COMPRESSION FITTING INTO
CORED WALL TAPPING TEE

WW4-02

EFFECTIVE DATE: JANUARY 1, 2018

NOT TO SCALE

DRAWING NUMBER